

Typical section - with ramp
Scale 1:20 @A1

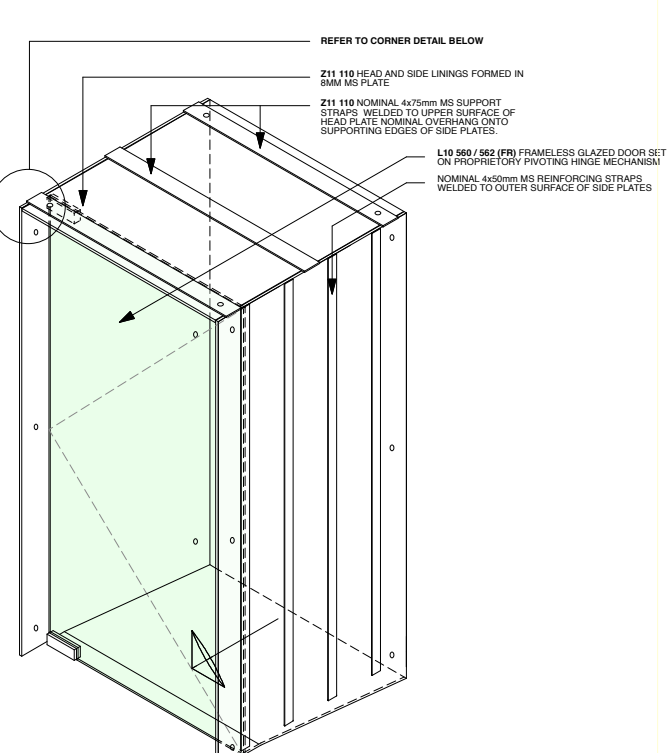

Typical configuration - with ramp
Scale 1:20 @A1

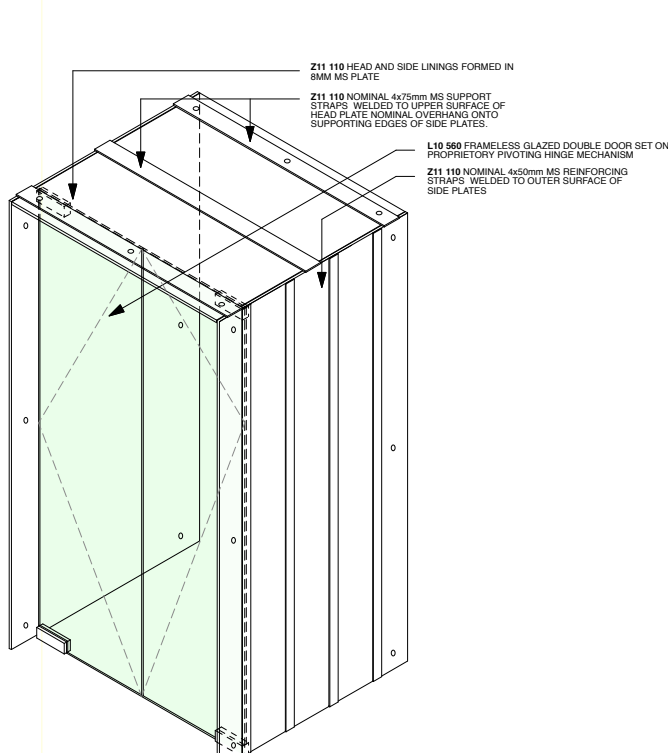

Typical configuration - double door
Scale 1:20 @A1

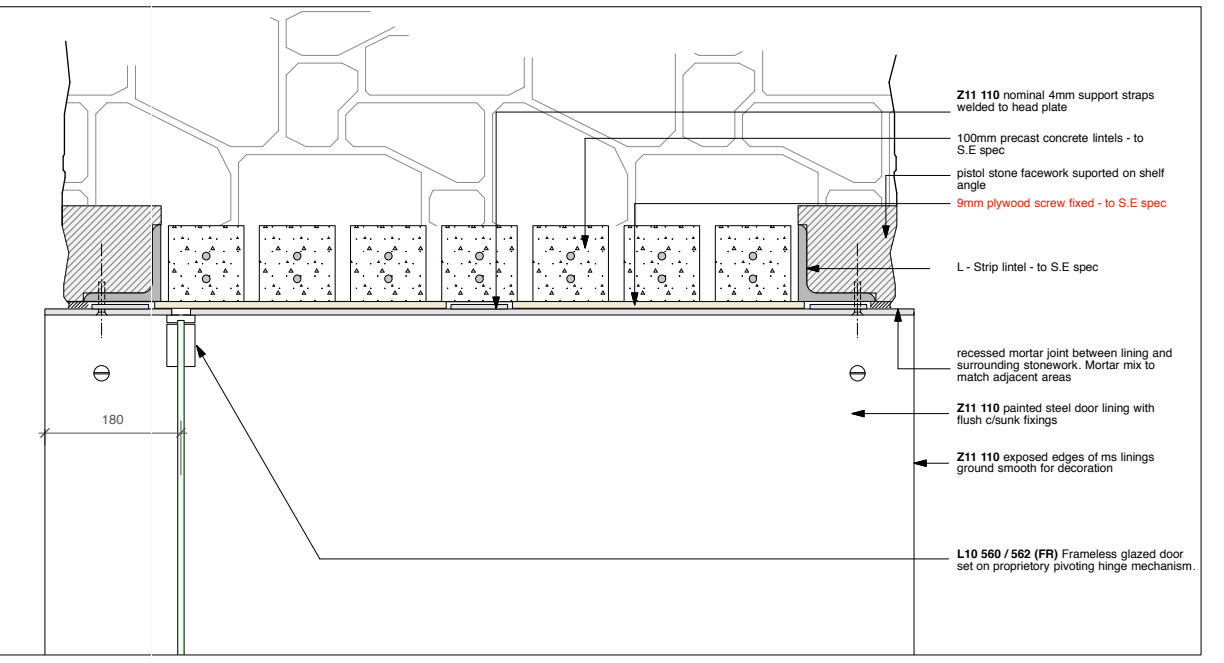

detail - head lining detail with door
Scale 1:5 @A1

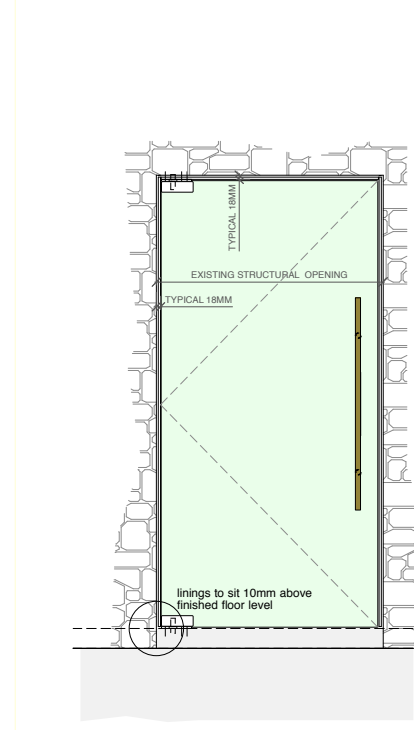

Typical elevation - with door
Scale 1:20 @A1

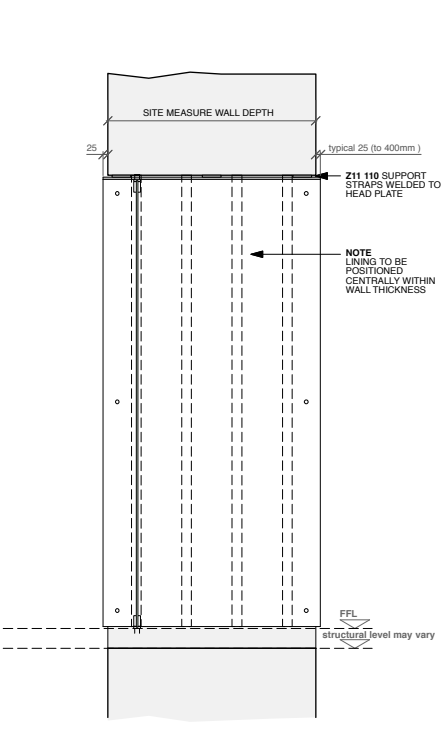

Typical section - with door
Scale 1:20 @A1

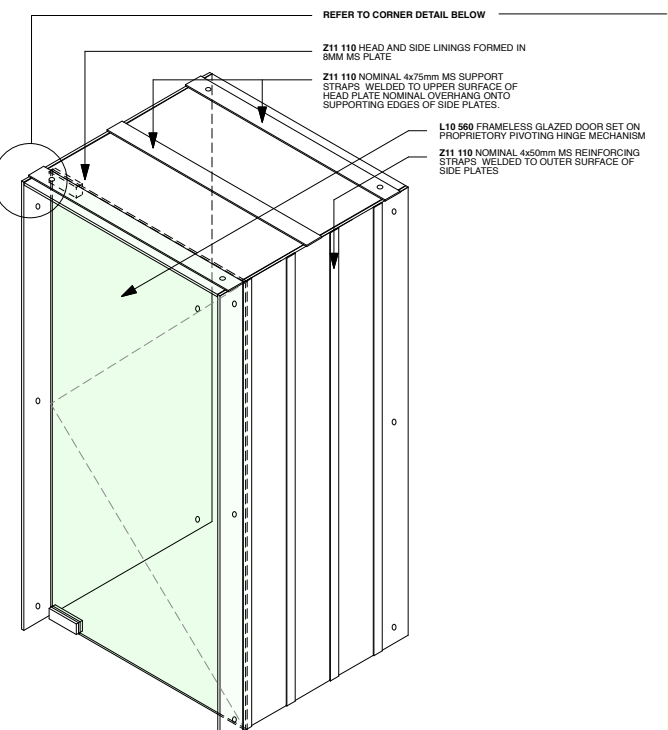

Typical configuration - with door
Scale 1:20 @A1

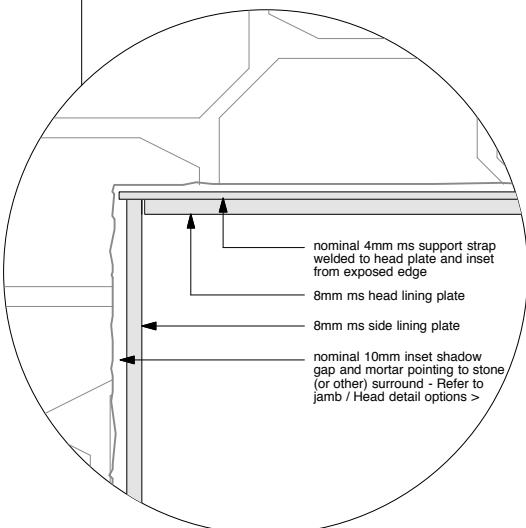

Detail Scale 1:2 @A1

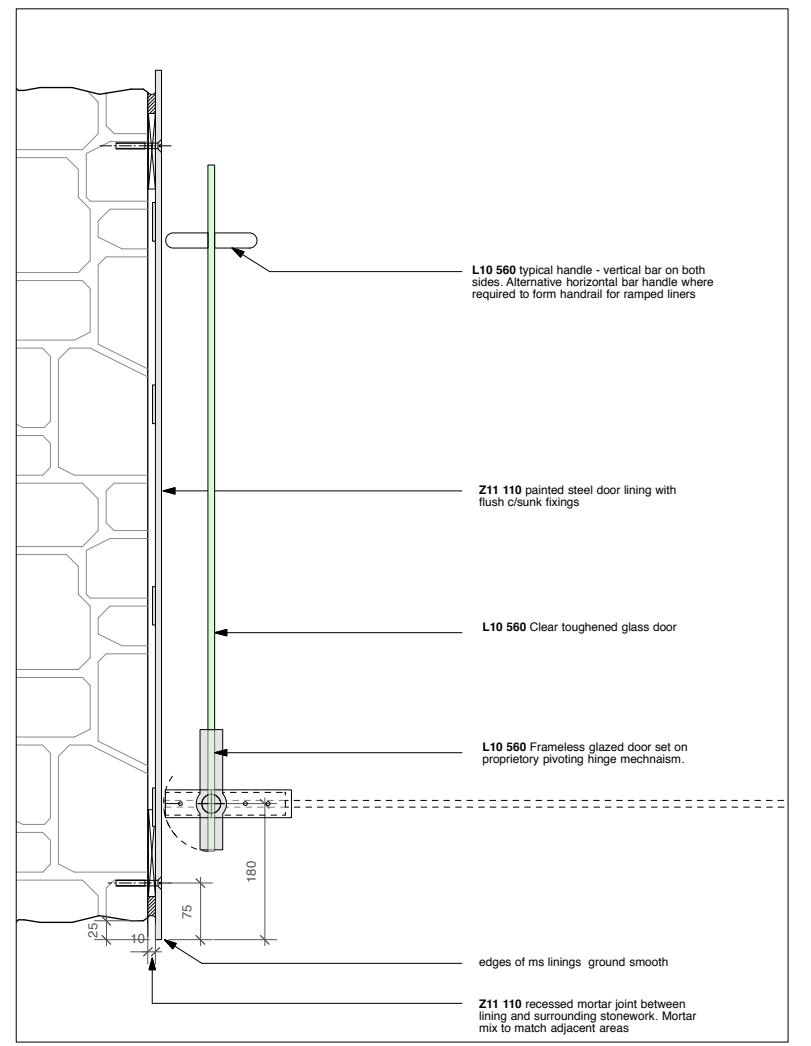

detail - jamb lining detail with door
Scale 1:5 @A1

general
<ul style="list-style-type: none"> all drawings are copyright do not scale drawing report all discrepancies to project administrator all dimensions to be checked on site

key

notes
1. Subcontractor to provide proposed c'sunk fixing detail for approval
2. Finish to steelwork to be painted - colour TBC by Architect
3. Thickness of proposed support straps to be designed by subcontractor.
4. size of all linings indicated to be checked against site openings

rev
T1: 14.03.19 - NBS Notation Added
T2: 10.04.19 - NBS Notation Updated to remove Fire Door Reference and superceded by C-014 drawing

project:	date:	scale:	drawn:
Tavistock Guildhall and Police Station	May 2017	Various @ A1 Various @ A3	sb
drawing title:	job no:	drawing no:	rev:
TTC: Details Steel threshold linings 02	1041	C-011	T2

Stage 4 - TENDER ISSUE