

Notes

1. J42 115 Dark grey single ply membrane
2. J42 115 Single ply lined gutter to falls
3. J42 115 Gutter formed with single ply membrane and lead flashing to upstands chased into existing stone wall
4. H73 250 Bronze coloured capping to parapet
5. L10 500 Bronze coloured thermally broken aluminium framed glazing system
6. X12 120 Lift door with bronze anodised finish
7. Steel to structural engineer's specification
8. X12 120 Proprietary lift structure
9. Step in wall moved to accommodate extension roof

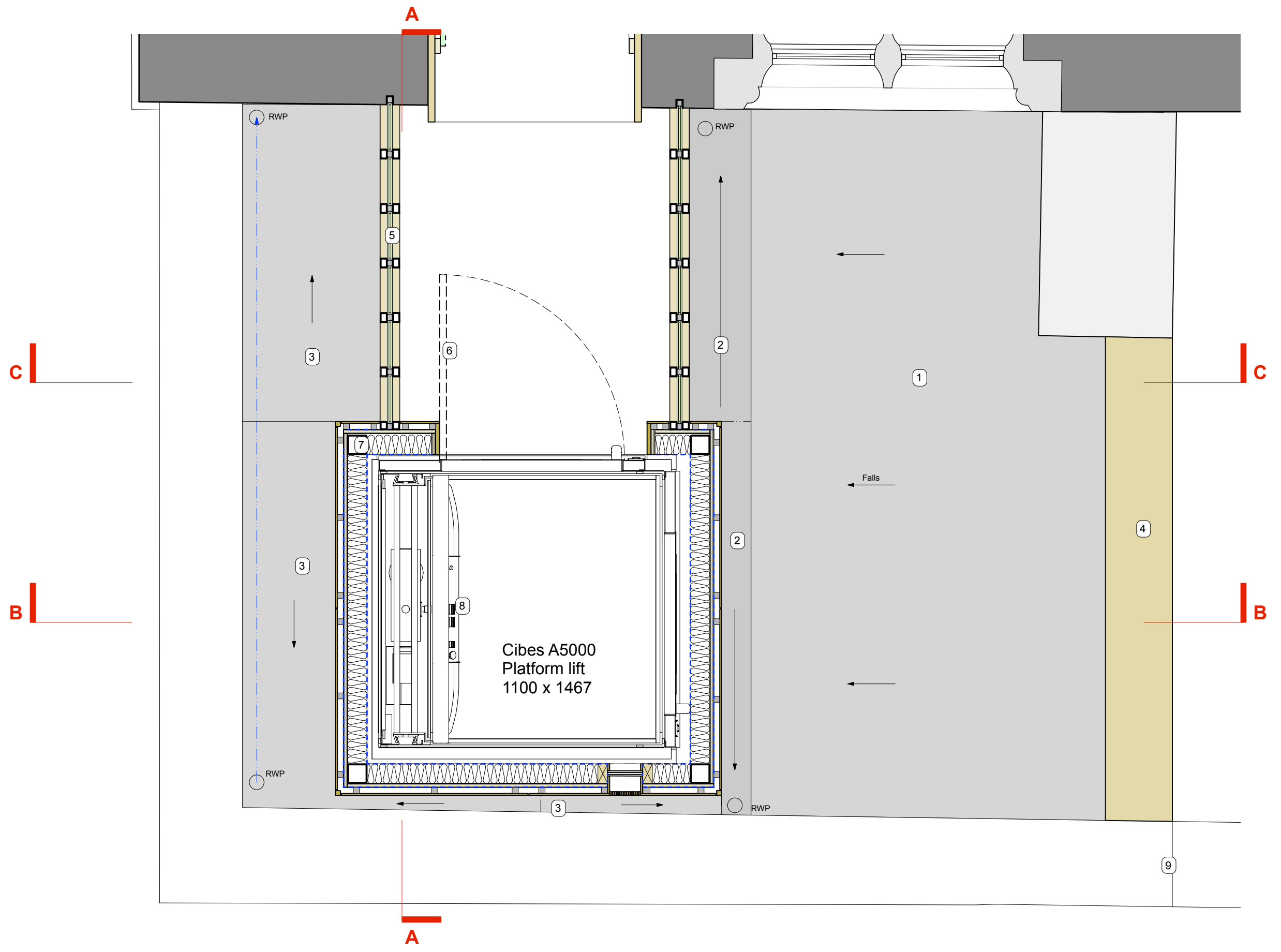

general
<ul style="list-style-type: none"> • all drawings are copyright • do not scale drawing • report all discrepancies to project administrator • all dimensions to be checked on site

key

notes

rev
T1: 21.03.19 - NBS Notation Added

Stage 4 - TENDER

project: Tavistock Guildhall & Police Station	date: Nov 2018	scale: 1:20 @ A3	drawn: FW
drawing title: Extension - First Floor Plan	job no: 1041	drawing no: C-334	rev: T1
gillespie yunnie architects			
Lower Tweed Mill Shimmers Bridge Dartington Devon TQ9 6JB t 01803 860010 f 01803 864929 e info@gyarchitects.co.uk			