

Ref: GD27

Location: LG20
Type: Existing - Steel / timber composite door.
Proposed Works: Existing door to be retained and made good where required by exhibition designer.
Ironmongery: To be retained as existing. Check and ease movement. Door to be pinned in open position.
Fire Rating: N/A
Acoustic Rating: N/A
Glazing: N/A
Repair Code: 1
Finish: To be made good if required by exhibition designer.
Spec Ref: L20 275 (Note: Exhibition Designer to be consulted)

Ref: GD28

Location: LG17
Type: Existing - timber horizontal panelled door with painted finish
Proposed Works: Existing door to be retained. Opening infilled and sealed to meet FD60. Any damaged surrounds to be made good.
Ironmongery: Removed and fixed shut.
Fire Rating: FD60 Partition
Acoustic Rating: N/A
Glazing: Existing frosted glass top plane retained.
Repair Code: N/A
Finish: N/A
Spec Ref: Refer to Detail A-307.

Ref: GD29

Location: LG13
Type: Existing - timber horizontal panelled door with painted finish to be removed and replaced with solid core fire door with grooves to match timber strip doors (as per GD41).
Proposed Works: Fitted as per manufacturers recommendations. Undercut door by 10mm - TBC by M+E Engineer.
Ironmongery: 3 - Standard 'd-line' type modern level handle. Hinges to be provided by door manufacturer. Door closer to be fitted. Mortice lock, suiting TBC by client.
Fire Rating: FD30S
Acoustic Rating: N/A
Glazing: None.
Repair Code: N/A
Finish: Spray laquered off site finished - Dark Grey - Colour TBC. Graphic to be confirmed by exhibition designer.
Spec Ref: L20 440

Ref: GD30

Location: LG10
Type: Existing - Ledge and braced panelled door with painted finish to be removed and replaced with solid core door to cubicle.
Proposed Works: Fitted as per manufacturers recommendations. Undercut door by 10mm - TBC by M+E Engineer.
Ironmongery: 4 - Standard 'd-line' type modern level handle. Hinges to be provided by door manufacturer. Thumbturn Lock to be fitted with indicator.
Fire Rating: N/A
Acoustic Rating: N/A
Glazing: N/A
Repair Code: N/A
Finish: Spray laquered off site finished - Colour TBC
Spec Ref: L20 430

Ref: GD31

Location: LG10
Type: Existing - Ledge and braced panelled door with painted finish to be removed and replaced with solid core door to cubicle.
Proposed Works: Fitted as per manufacturers recommendations. Undercut door by 10mm - TBC by M+E Engineer.
Ironmongery: 4 - Standard 'd-line' type modern level handle. Hinges to be provided by door manufacturer. Thumbturn Lock to be fitted with indicator.
Fire Rating: N/A
Acoustic Rating: N/A
Glazing: N/A
Repair Code: N/A
Finish: Spray laquered off site finished - Colour TBC
Spec Ref: L20 430

Ref: GD32

Location: LG07 (existing door in LG06)
Type: Existing - timber horizontal panelled door with painted finish to be removed and replaced with solid core door.
Proposed Works: Fitted as per manufacturers recommendation. Undercut door by 10mm - TBC by M+E Engineer.
Ironmongery: 4 - Standard 'd-line' type modern level handle. Hinges to be provided by door manufacturer. Thumbturn Lock to be fitted with indicator.
Fire Rating: N/A
Acoustic Rating: N/A
Glazing: N/A
Repair Code: N/A
Finish: Spray laquered off site finished - Colour TBC
Spec Ref: L20 430

Ref: GD33

Location: LG07 (existing door in LG06)
Type: Existing - timber horizontal panelled door with painted finish to be removed and replaced with solid core door.
Proposed Works: Fitted as per manufacturers recommendations. Undercut door by 10mm - TBC by M+E Engineer.
Ironmongery: 4 - Standard 'd-line' type modern level handle. Hinges to be provided by door manufacturer. Thumbturn Lock to be fitted with indicator.
Fire Rating: N/A
Acoustic Rating: N/A
Glazing: N/A
Repair Code: N/A
Finish: Spray laquered off site finished - Colour TBC
Spec Ref: L20 440

Ref: GD35

Location: LG11
Type: Existing - timber door with painted finish to be removed and replaced with solid core fire door.
Proposed Works: Fitted as per manufacturers recommendations
Ironmongery: 5 - Standard 'd-line' type modern level handle. Hinges to be provided by door manufacturer. Mortice lock, suiting TBC by client.
Fire Rating: FD30S
Acoustic Rating: N/A
Glazing: N/A
Repair Code: N/A
Finish: Spray laquered off site finished - Colour TBC. Graphic to be confirmed by exhibition designer.
Spec Ref: L20 440

Ref: GD47

Location: LG16
Type: New solid core door.
Proposed Works: Fitted as per manufacturers recommendations
Ironmongery: 6A - Standard 'd-line' type modern level handle. Hinges to be provided by door manufacturer.
Fire Rating: N/A
Acoustic Rating: N/A
Glazing: N/A
Repair Code: N/A
Finish: Spray laquered off site finished - Colour TBC. Graphic to be confirmed by exhibition designer
Spec Ref: L20 430

Window Key - Guildhall Ground Floor Plan as existing - 1:200 @ A1

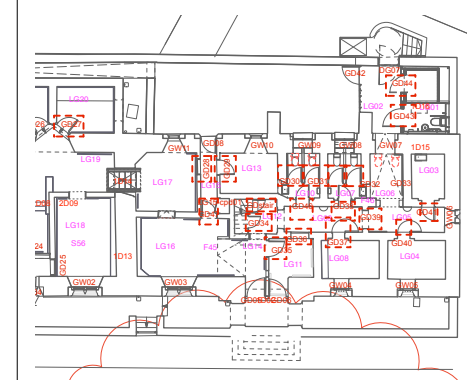

Ref: GDstair

Location: LG12
Type: Existing - timber stair door with painted finish
Proposed Works: Existing door to be retained and made good where required.
Ironmongery: As existing. Check and ease movement. Allow for 'heritage pin' to wall to hold open in normal circumstances.
Fire Rating: N/A
Acoustic Rating: N/A
Glazing: None.
Repair Code: 1
Finish: White - TBC
Spec Ref: L20 275

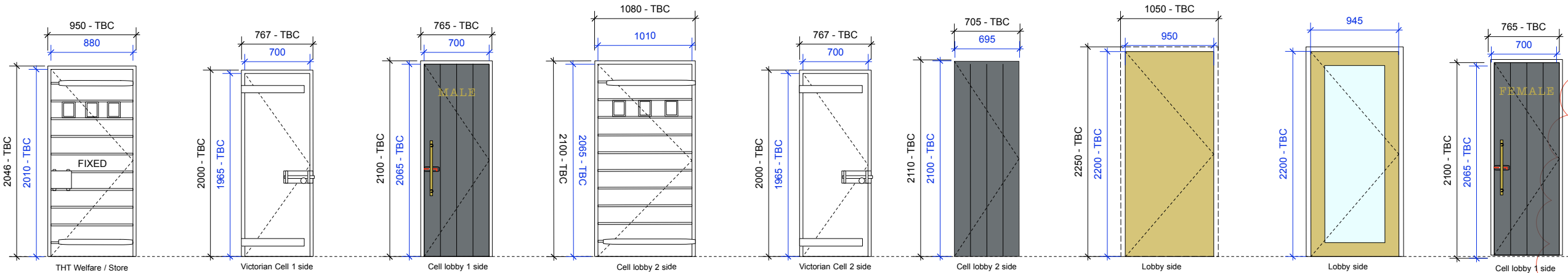

Ref: GD36

Location: LG11
Type: Existing - timber cell door.
Proposed Works: Existing door to be retained and made good where required by exhibition designer.
Ironmongery: To be retained as existing. Door to be Fixed Shut.
Fire Rating: N/A
Acoustic Rating: N/A
Glazing: N/A
Repair Code: 1
Finish: To be made good if required by exhibition designer.
Spec Ref: L20 275 (Note: Exhibition Designer to be consulted)

Ref: GD37

Location: LG08
Type: Existing - timber cell door.
Proposed Works: Existing door to be retained and made good where required by exhibition designer.
Ironmongery: To be retained as existing. Check and ease movement to enable to pin shut.
Fire Rating: N/A
Acoustic Rating: N/A
Glazing: N/A
Repair Code: 1
Finish: To be made good if required by exhibition designer. Graffiti marks to be retained.
Spec Ref: L20 275 (Note: Exhibition Designer to be consulted) Note no architraves or frame. Fitted on 'hook on' pin hinges.

Ref: GD38

Location: LG09
Type: Existing - timber door.
Proposed Works: Existing door to be retained and made good where required. Undercut door by 10mm - TBC by M+E Engineer.
Ironmongery: 7 - Push Plate to be provided on WC Side / Pull Handle on Corridor Side - TBC. Lock Removed. Replace hinges.
Fire Rating: N/A
Acoustic Rating: N/A
Glazing: N/A
Repair Code: 2
Finish: Dark Grey - Colour TBC. Graphic to be confirmed by exhibition designer.
Spec Ref: L20 275

Ref: GD39

Location: LG05
Type: Existing - timber corridor door.
Proposed Works: Existing door to be retained and made good where required by exhibition designer. Refixed on wall adjacent to opening (LG05) to allow for adjacent cell door (GD37) to be kept open.
Ironmongery: To be retained as existing. Check and ease movement. Door to be fixed to corridor wall.
Fire Rating: N/A
Acoustic Rating: N/A
Glazing: N/A
Repair Code: 1
Finish: To be made good if required by exhibition designer.

Ref: GD40

Location: LG04
Type: New - timber cell door to match GD37
Proposed Works: New replica door to match GD37
Ironmongery: To match GD37 + pin shut
Fire Rating: N/A
Acoustic Rating: N/A
Glazing: N/A
Repair Code: N/A
Finish: To match GD37
Spec Ref: L20 400 - To match GD37 - Note no architraves or frame. Fitted on 'hook on' pin hinges.

Ref: GD41

Location: LG03
Type: New - solid core door with grooves to match timber strip doors.
Proposed Works: Fitted as per manufacturers recommendations
Ironmongery: 5 - Standard 'd-line' type modern level handle. Hinges to be provided by door manufacturer. Mortice lock, suiting TBC by client.
Fire Rating: FD30S
Acoustic Rating: N/A
Glazing: N/A
Repair Code: N/A
Finish: To match GD38. Dark Grey - Colour TBC
Spec Ref: L20 440

Ref: GD43

Location: LG02
Type: New Metal Clad Door to match Lift Finish TBC.
Proposed Works: Fitted as per manufacturers recommendation. Undercut door by 10mm - TBC by M+E Engineer.
Ironmongery: 8 - To be provided by manufacturer. TBC. Accessible Fittings including thumbturn lock with indicator. Access WC Signage.
Fire Rating: N/A
Acoustic Rating: N/A
Glazing: N/A
Repair Code: N/A
Finish: Anodic Bronze to match Lift Cladding - TBC. Accessible WC Signage.
Spec Ref: L20 430 + Metal Clad Face.

Ref: GD44

Location: LG01
Type: New Door Supplied by Lift Manufacturer
Proposed Works: Fitted as per manufacturers recommendations
Ironmongery: L - To be provided by manufacturer. Open Access.
Fire Rating: N/A
Acoustic Rating: N/A
Glazing: N/A
Repair Code: N/A
Finish: Anodic Bronze to match Lift with glazed panel - TBC
Spec Ref: X12 120

Ref: GD46

Location: LG09
Type: New - timber door to match GD38. TBC.
Proposed Works: Existing door to be retained and made good where required.
Ironmongery: 7 - Push Plate to be provided on WC Side / Pull Handle on Corridor Side - TBC.
Fire Rating: N/A
Acoustic Rating: N/A
Glazing: N/A
Repair Code: N/A
Finish: Dark Grey - Colour TBC. Graphic to be confirmed by exhibition designer.
Spec Ref: L20 430 + Grooves in MDF.

Ref: GD34

Location: LG12
Type: Existing - timber understair cupboard door with painted finish
Proposed Works: Existing door to be retained and made good where required.
Ironmongery: As existing. Check and ease movement.
Fire Rating: N/A
Acoustic Rating: N/A
Glazing: None.
Repair Code: 1
Finish: White - TBC
Spec Ref: L20 275

Ref: LG15-cpd01

Location: LG15
Type: Existing - timber understair cupboard door with painted finish
Proposed Works: Existing door to be retained and made good where required.
Ironmongery: As existing. Check and ease movement.
Fire Rating: N/A
Acoustic Rating: N/A
Glazing: None.
Repair Code: 1
Finish: White - TBC
Spec Ref: L20 275

general
<ul style="list-style-type: none"> all drawings are copyright do not scale drawing report all discrepancies to project administrator all dimensions to be checked on site

key

notes
<p>Stage 4 - Tender</p> <p>All dimensions to be checked on site. Note: Door undercuts and Louvre Panels to be confirmed by M+E Engineer</p>

rev
<p>T1: 21.03.19 - Door Updates as noted in red or bubbled</p> <p>T2: 29.03.19 - Door Updates as noted in red or bubbled + LG15 - Cpd</p>

project title: Tavistock Guildhall and Police Station	date: October 2018	scale: 1:25 @ A1 1:50 @ A3	drawn: cm
drawing title: Internal Door Schedule 2 - Ground Floor	job no: 1041	drawing no: C-381	rev: T2
gillespie yunnie architects			
Lower Tweed Mill Shimmers Bridge Dartington Devon TQ9 6JB 01803 860010 01803 864929 e:info@gyarchitects.co.uk			