

Ref:	Legend
Door repair codes	
1.	Good - sound and operational - prepare surfaces and redecorate.
2.	Intact - ease and free-up moving parts, address surface defects, adjust, redecorate.
3.	Moderate - Requires repair, adjustment, refurbishment prior to redecoration.
4.	Poor - significant repairs, alterations or new components needed to make operational. Adjust, redecorate.
5.	Beyond economic repair - remove. Prepare opening for replacement unit.

Ref: 1D02
Location: F47
Type: Existing - timber panelled double doors with painted finish
Proposed Works: Existing door to be retained and made good where required.
Ironmongery: New antique brass knob / bronze + associated ironmongery. Retain key lock.
Fire Rating: N/A
Acoustic Rating: N/A
Glazing: Existing Small Diamond Shaped Glass Retained.
Repair Code: 2
Finish: White - Colour TBC.
Spec Ref: L20 275

Ref: 1D15
Location: F46
Type: Proposed - Glazed single door with steel lined surround
Proposed Works: Toughened glass single door fixed at jambs using specialist hinges. Door opening lined with Bronze polyester powder coated steel surround.
Ironmongery: 1D - Hinges to be provided by door manufacturer. Sprung Door closer with 90° hold open. Bronze 'bar' handles fixed to both sides of door. No Locks.
Fire Rating: N/A
Acoustic Rating: N/A
Glazing: Toughened clear laminate glazing with manifestation - TBC
Repair Code: N/A
Finish:
Spec Ref: L10 560

Ref: 1D16
Location: F48
Type: New Door Supplied by Lift Manufacturer
Proposed Works: Fitted as per manufacturers recommendations
Ironmongery: L - To be provided by manufacturer. Open Access.
Fire Rating: N/A
Acoustic Rating: N/A
Glazing: N/A
Repair Code: N/A
Finish: Anodic Bronze to match Lift with glazed panel - TBC
Spec Ref: X12 120

Ref: 1D17
Location: F35
Type: Existing - timber panelled door with painted finish. Access to 2nd Floor from Stair 1 First Floor.
Proposed Works: Existing door to be retained and made good where required.
Ironmongery: As existing. Check and ease movement. Remove bolt lock.
Fire Rating: N/A
Acoustic Rating: N/A
Glazing: None.
Repair Code: 2
Finish: White - Colour TBC.
Spec Ref: L20 275

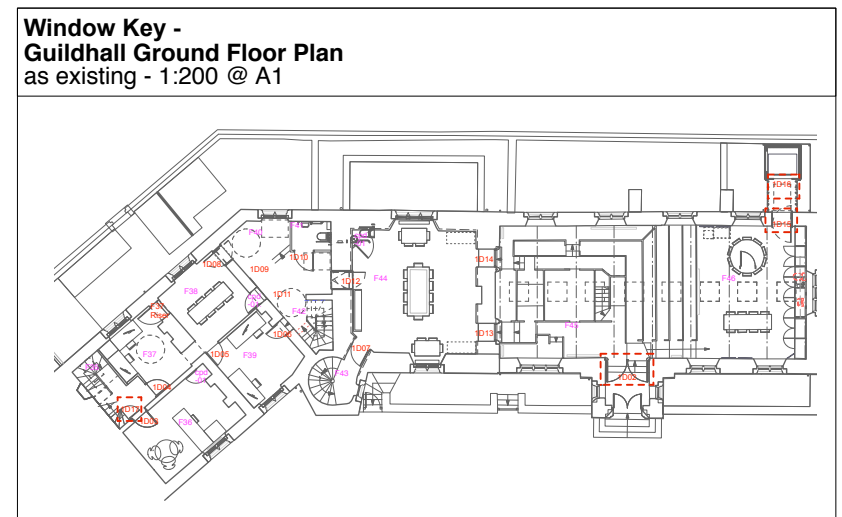

general

- all drawings are copyright
- do not scale drawing
- report all discrepancies to project administrator
- all dimensions to be checked on site

key

notes
Stage 4 - Tender
 All dimensions to be checked on site.
Note: Door undercuts and Louvre Panels to be confirmed by M+E Engineer

rev
T1: 21.03.19 - Door Updates as noted in red or bubbled

project title: Tavistock Guildhall and Police Station	date: October 2018	scale: 1:25 @ A1 1:50 @ A3	drawn: cm
drawing title: Internal Door Schedule 4 - First Floor	job no: 1041	drawing no: C-383	rev: T1
gillespie yunnie architects			
Lower Tweed Mill Shimmers Bridge Dartington Devon TQ9 6JB t 01803 860010 f 01803 864929 e info@gyarchitects.co.uk			