

- SKIRTINGS KEY:**(refer to specification for full details)
- S1 Existing skirtings retained in situ (if present) + redecorate dashed = new skirting to match - P20 105
  - S2 Existing skirtings carefully removed and reinstated following works to floors where condition allows. Where not possible recreation skirting used. Dashed = new skirting to match - P20 105
  - S3 M40 118 - New ceramic tile skirting to match floor tile

- S4 P20 110 - New 195mm high timber square skirting
- S5 P20 115 - New 119mm high timber square skirting
- S6 10mm shadow gap
- no line No new skirting added.
- J7 New courtroom paneling up to window cill height to match existing > > > >



- INTERNAL THRESHOLD DETAILS**  
Refer to Internal Threshold Details
- T1 - Eng. Timber Floor / Existing Floor
  - T2 - Eng. Timber Floor / Carpet
  - T3 - Ramp / Lino
  - T4 - Ramp / Existing Floor
  - T5 - Eng. Timber Floor / Painted Existing Floor
  - T6 - Eng. Timber Floor / Ramp
  - T7 - Ramp / Carpet
  - T8 - Eng. Timber Floor / Carpet (@ STEP)
  - T9 - Lino / Carpet

- ARCHITRAVE / LINING DETAILS**  
Refer to NBS Specification
- EA - Existing Door Architrave
  - NA1 - P20 120: New Door Architrave 1
  - NA2 - P20 125: New Door Architrave 2
  - SL1 - Z11 100: Steel Lining to Opening
  - SL2 - Z11 110: Steel Lining with 'Frameless' Glass Door
  - FD - Denotes Fire Door for all of above.

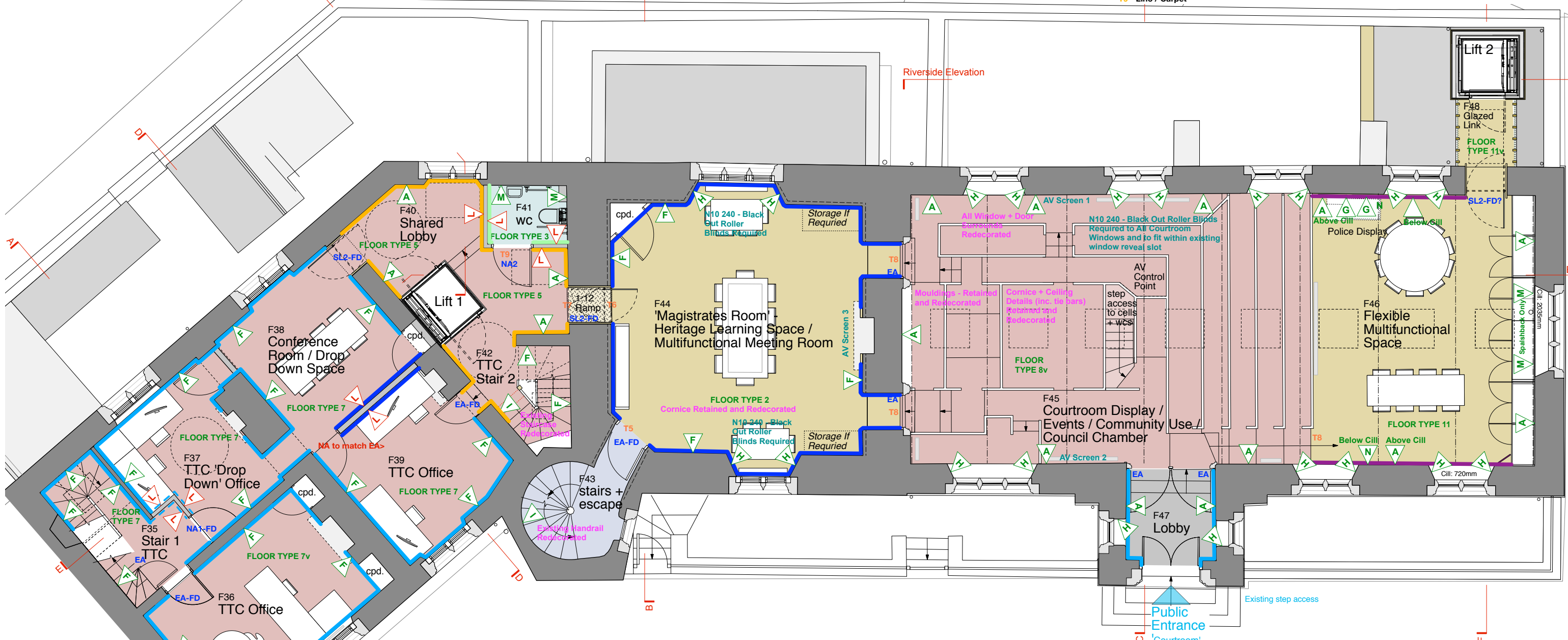

**floor type key:**

- FLOOR TYPE 1 Existing ceiling, strengthened floor structure, new deck
- FLOOR TYPE 2 New suspended ceiling, existing floor structure, new deck
- FLOOR TYPE 3 New suspended ceiling, new floor structure, new deck
- FLOOR TYPE 4 Existing ceiling, existing floor structure, new deck
- FLOOR TYPE 5 New suspended ceiling, new floor structure, new deck
- FLOOR TYPE 6 New concrete slab
- FLOOR TYPE 7 New suspended ceiling, existing floor structure, existing deck
- FLOOR TYPE 8 Existing floor structure
- FLOOR TYPE 9 New limecrete slab
- FLOOR TYPE 10 New raised floor
- FLOOR TYPE 11 New timber floor

**floor finish key:**

- Engineered timber - K21 145
- Carpet - M50 140 / 145 / 148
- Existing floor finish cleaned / regouted
- Lino - M50 150
- Existing finishes cleaned
- Tiles
- Floor Paint with contrasting nosings - existing lino stripped from stairs - M60 180
- 'Diamond plate' ramp - Z11 120

**wall type key:**

- A Existing plaster reskimmed and painted
- B Lightly cleaned and limewashed
- C Skimcoated plasterboard and paint
- D Cleaned
- E Tiles to masonry walls
- F Existing walls painted
- G Exhibition Display Fixed to Wall
- H Existing finishes stripped with new lime plaster finish
- I Existing finishes stripped with new limewash finish
- J Plywood
- K Bronze finish
- L Plasterboard finish to timber stud walls
- M Tiled finish to new stud walls
- N Joinery paneling to match existing courtroom paneling up to window cill height

tavistock guildhall TTC first floor as proposed

**general**

- all drawings are copyright
- do not scale drawing
- report all discrepancies to project administrator
- all dimensions to be checked on site

**key**

**notes**

**Stage 4 - TENDER**

- All dimensions are based upon survey information supplied by others. All dimensions to be confirmed on site prior to construction. GYA take no responsibility for issues arising from inaccuracies in survey data.
- This drawing is not intended for construction purposes.
- Copyright to remain Gillespie Yunnie Architects Ltd.

**rev**

- T1: 07.03.19 - NBS Specification References Added to Notation
- T2: 14.03.19 - Architrave Notation Added, Bubbled Changes and Ramp Finish Added
- T3: 25.04.19 - Updates indicated in red

project: Tavistock Guildhall and Police Station	date: Nov 2013	scale: 1:50 @ A1 1:100 @ A3	drawn: if
drawing title: Finishes: 1st Floor Plan	job no: 1041	drawing no: GA-152	rev: T3
<b>gillespie yunnie architects</b>			